

Fontana Luna Goose Neck Matte Black Finish Freestanding Dual Automatic Commercial Sensor Faucet



Specifications:

Spout: Solid Brass
Power: 4 (AA) Batteries / AC Adapter
Optional
Battery life expectancy: 300,000 cycles
Solenoid valve: 6 Volt magnet latching
Working Water Pressure: 1 PSI -100 PSI
Supply Inlet Size: 1/2" NPT Male
Water Temperature Control: Optional
Pop-Up Drain Rod: Optional
Sensor type and Location: Active
Infrared, Base mount
Sensor Microprocessor: Digital, Plug And Play
Sensing Range: 2" to 8" Adjustable
Response Time: 0.3 Second
Shut-Off Delay Time: 2 Seconds
Maximum Running Time: 60 Seconds
Particle filter size: 50 Micron
Aerator: 1.5 GPM Standard, Options
Available

Size:

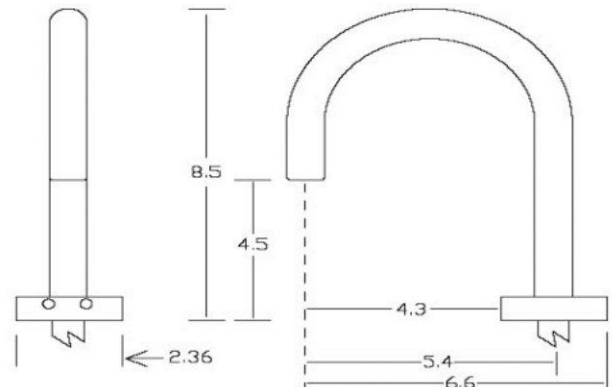

Fontana Luna Goose Neck Matte Black Finish Freestanding Dual Automatic Soap Dispenser



Specifications:

Spout: Solid Brass

Power: 4 (D) Batteries / AC Adapter
Optional

Soap Pump: 6 Volt Noise-Free PERISTALTIC Pump System

Counter Accommodations: Please
View Rough-in Drawings on Page Two
Sensor type: Active Infrared, Self-Adjusting

Sensing Range: Adjustable with optional remote control

Working Soap: Standard liquid Soap.
NO Grit (industrial) Soap

Soap Bottle Capacity: 800ML (Just Under a quart) optional 1 gallon containers

Soap Amount Per Use: 0.5ML to 1.5ML, adjustable with optional remote control

Remote Control: OPTIONAL.

Finish Selection: 20+ Finishes to Match MAC Faucets and MAC Flush Valves

